

INSTALLATION INSTRUCTIONS

Wooden battens, walls

These instructions apply to installation of wooden battens for wall cladding, minimum 20x90 mm or 45x90 mm. Note, the 20x90mm can be achieved by combining two 20x45 mm battens side by side. Download installation instructions for all Troldekt® panel types from www.troldekt.co.nz.

INSTALLATION OF WOODEN BATTENS

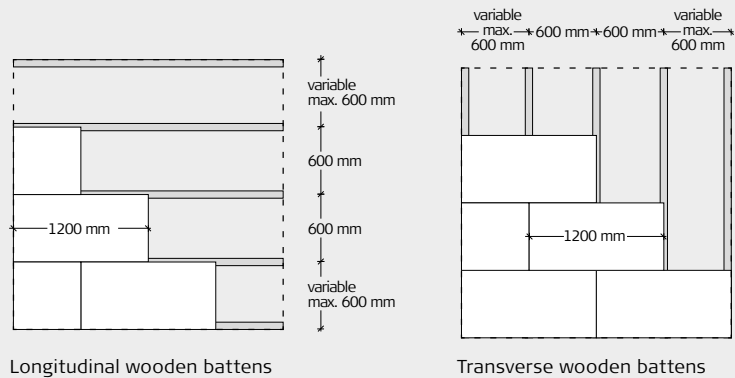

VAPOUR BARRIER

If you need to install a vapour barrier, we recommend using polyethylene. The vapour barrier must be placed behind the wooden battens. Install the vapour barrier tightly against the insulation.

Please refer to the manufacturer's instructions.

BALL IMPACT CERTIFICATION

Troldekt panels have been tested for the certification to withstand ball impacts in accordance with the German 'Prüfung der Ballwurfsicherheit, DIN 18032 Teil 3, Sportshallen für Turnen und Spiele' (requirements and testing of ball impact safety, DIN 18032, Part 3, sports facilities).

A large number of structures using Troldekt have been tested at the Stuttgart institute and are certified for use as ceiling and wall cladding in sports halls, where they will be exposed to high impact, e.g. when a handball is thrown at full speed.

Download the ball impact tests from www.troldekt.co.nz.

STRUCTURAL SOFFIT

Concrete
Minimum: 20x90 mm
or 45x90 mm
wooden battens

Troldekt panels

Insulation

Post/structure

Vapour barrier

Minimum: 20x90 mm
or 45x90 mm
wooden battens

Troldekt panels

