

# INSTALLATION INSTRUCTIONS

## Wooden battens, ceilings

These instructions apply to installation of wooden battens for ceiling cladding, minimum 20x90 mm or 45x90 mm. Note, the 20x90mm can be achieved by combining two 20x45 mm battens side by side.

Download installation instructions for all Troldekt® panel types from [www.troldekt.co.nz](http://www.troldekt.co.nz).

### INSTALLATION OF WOODEN BATTENS

Troldekt panels are most often installed on longitudinal wooden battens, but transversal battens are just as applicable (except for Plus panels).

Note, however, the tolerances of the Troldekt panels. If the panels are very dry, they could be undersized, which could cause problems on very large surfaces with transversal wooden battens.

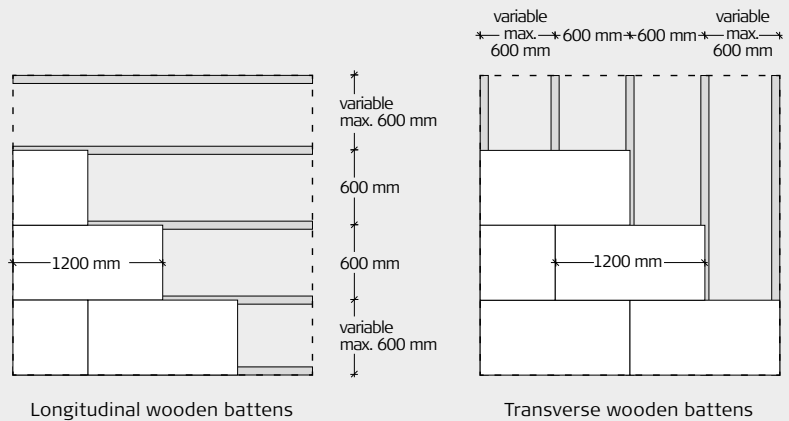

### VAPOUR BARRIER

If you need to install a vapour barrier, we recommend using polyethylene.

The vapour barrier must be placed behind the wooden battens. Install the vapour barrier tightly against the insulation.

Please refer to the manufacturer's instructions.

### STRUCTURAL SOFFIT

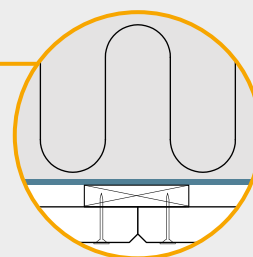
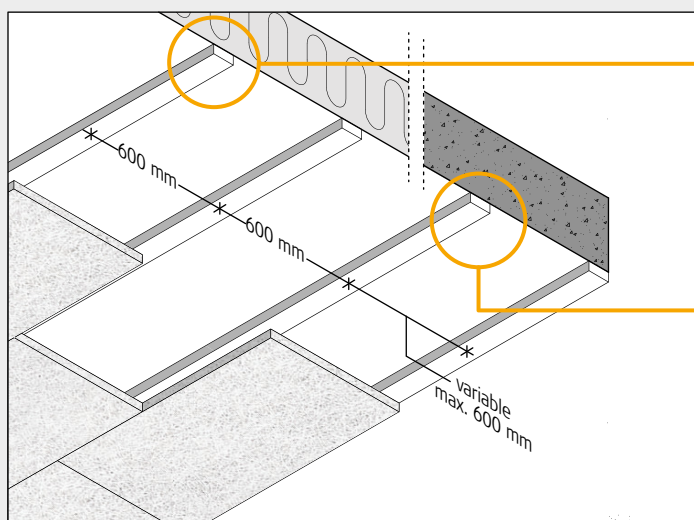

Insulation  
Post/structure  
Vapour barrier  
Minimum: 20x90 mm or 45x90 mm wooden battens  
Troldekt panels

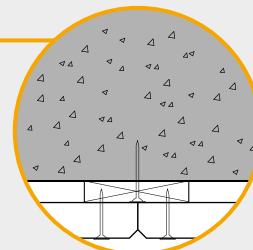

Concrete  
Minimum: 20x90 mm or 45x90 mm wooden battens  
Troldekt panels